

BELMONT GARDEN® FLEXEND FIREMAN HOSE™

www.belmont.garden

INSTRUCTIONS:

1. Remove the FlexEnd Fireman Hose™ from the package and completely unravel your FlexEnd Fireman Hose™.
2. Attach the spray nozzle (included) to the outlet of the FlexEnd Fireman Hose™ (figure 1). Make sure only 1 rubber washer is in place.
3. Attach the other end of your FlexEnd Fireman Hose™ inlet to the water supply of your home (figure 1). Make sure only 1 rubber washer is in place.
4. Turn on the faucet from your home's water supply to start using the FlexEnd Fireman Hose™.

① Assemble hose to faucet

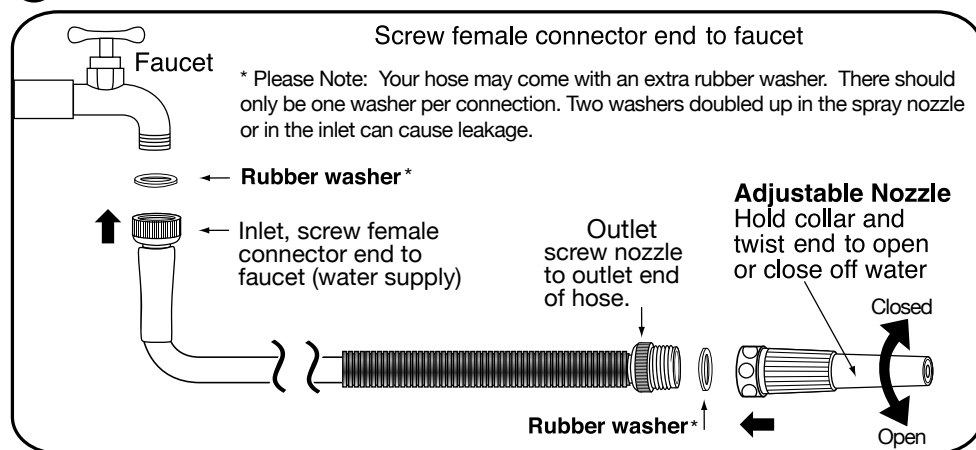

② Storing your hose

You can store your FlexEnd Fireman Hose™ on just about any common hose reel or simply coil your hose next to your faucet.

TIP: When you are finished watering with your FlexEnd Fireman Hose™ It's best to release the water pressure from your hose before storing.

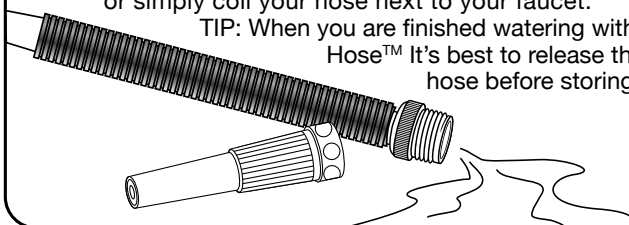

001219 FEHHPN Inst rev3b

2020 © Yeiser Research & Development, Belmont Garden® and FlexEnd Fireman Hose™. Trade names, product names, patterns, prints, images and logos used in this document are the trademark or registered trademarks of YRD LLC, Santee, CA 92071 WORLD WIDE PATENTS PENDING

A few ideas for how to use your FlexEnd Fireman Hose™:

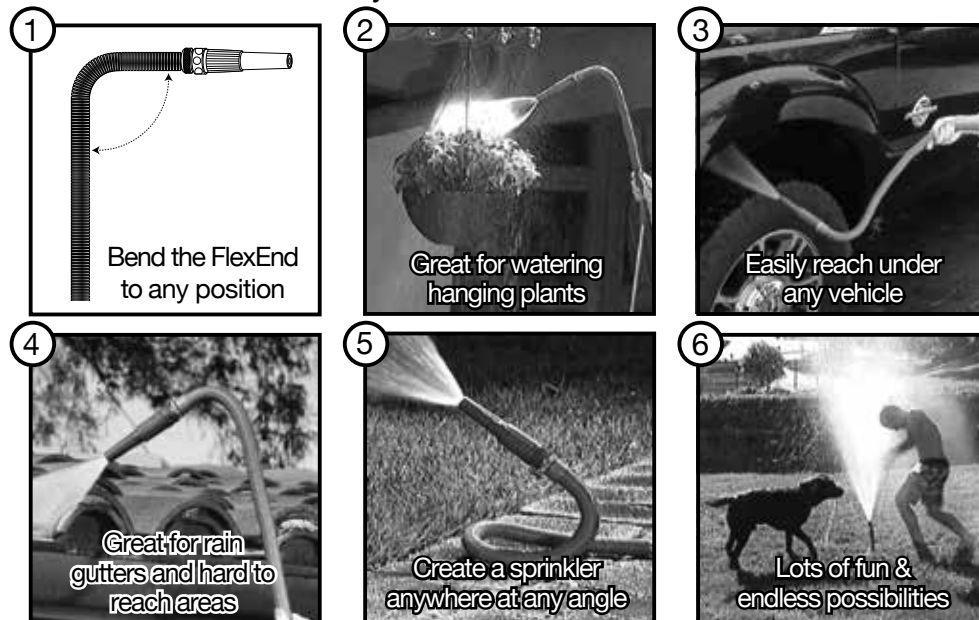

⚠ WARNING

WARNING: This product can expose you to chemicals including lead and lead Compounds which are known to the State of California to cause cancer and birth defects or other reproductive harm. For more info go to www.P65Warnings.ca.gov.

- The water in ANY garden hose may become contaminated & cause serious health effects.
- Strangulation hazard. Hose wrapped around neck may cause serious injury or death.
- Keep out of reach of children.
- For general OUTDOOR use ONLY in applications under 80 psi.
- DO NOT use this hose for commercial applications, in hot water applications, or high pressure applications. Doing so may cause serious personal injury and or damage or destroy the product. However you can use it on the low pressure inlet side of a high pressure washer.
- DO NOT leave this product unattended when it is in use or under pressure.
- This product is NOT A TOY.

LIMITED ONE YEAR WARRANTY

For warranty info please refer to our website at: www.belmont.garden/warrantyinfo.html. Call us for assistance at +1 (619) 449-2392 or you can email or mail us at: 9545 Pathway Street, Santee, CA 92071 customer@belmont.garden Our Customer Care Department is available: Monday - Friday 8:30am to 4:00pm PST / 11:30am - 7:00pm EST



LIMITATION OF LIABILITY

Liability limited to the purchase price of this product. YRD LLC shall not be liable for any incidental or consequential damages or any implied warranty on this product. Some states do not allow the exclusion or limitation of incidental or consequential damages, so the above limitation or exclusion may not apply to you.