



Instant Wine Aerator

USER MANUAL

SAVE THIS MANUAL FOR FUTURE REFERENCE



Table of Contents

Section 1. Information	01
1.1 – Introduction	01
1.2 – Safety Warnings	02
Section 2. Product Parts	03
Section 3. Product Information	03
3.1 – What is the Waerator Instant Wine Aerator?	03
3.2 – Battery Information	04
3.3 – Specifications	06
Section 4. Cleaning the Waerator	09
Section 5. How to Use the Waerator	07
Section 6. Storage	09
Section 7. Disposal at End-of-Life	09
Section 8. Warranty	10
8.1 – Violation	10
8.2 – Information	10

Section 1. Information

1.1 – Introduction

This user manual will guide you through the functions and usage of your Waerator Instant Wine Aerator. It is important that you follow all instructions and regard all notes that appear throughout this manual. Consult this manual before you attempt to use your Aerator. If you have questions not answered by this manual or are in need of service, contact customer support at 855-850-8035. Before contacting customer support, please have your purchase information ready as this may be needed during the call. This information may be recorded below.

Date of Purchase: _____

Place of Purchase: _____

1.2 – Safety Warnings

When reading this manual, note these icons:

 **Notes with this icon MUST be read, understood, and obeyed to prevent injury or damage etc.**

 **Notes with this icon include relevant information.**

Overall Usage

- *The Aerator is not a toy. Do not leave children unsupervised around the Aerator.*
- *Use only the parts included in the original packaging or received from Waerator.*
- *Properly dispose of all packaging material. Some items may be packed in plastic bags or material and may cause suffocation or injury to pets or children.*
- *Do not place heavy weights on the Aerator or any of its accessories.*
- *Do not place the Aerator near any source of significant heat or combustible materials.*

- *Store the Aerator indoors at a dry and stable temperature. Do not store in an unheated garage, shed, or other location with extreme temperature fluctuations.*
- *Never spray liquid directly onto any part of the Aerator. Only wine and water may only come in direct contact with the tubes, nozzle, and injection openings.*
- *After cleaning the Aerator, allow 24 hours for it to dry. Check all parts before reinstalling.*
- *Never use cleaning solutions. Only water may be used during cleaning.*
- *Do not expose the Aerator's Electric parts to water, moisture, or liquids.*
- *Do not use the Aerator for any purpose other than described in this user manual.*

Battery & Charging

- *If storing the Aerator for more than 1 month, remove the batteries and store separately.*
- *If the battery compartment or surrounding parts are damaged, do not use the Aerator.*
- *After receiving the low battery notification, replace the batteries within two weeks.*
- *Use only four alkaline AAA batteries.*
- *Do not mix old and new batteries or batteries from different brands.*
- *Please ensure the Aerator's cover is fully installed over the battery compartment before use.*

Section 2. Product Parts

- A Button
- B Cover
- C Body
- D Spout
- E Tube
- F Indicator
- G Battery Compartment
- H Nozzle
- I Injection Openings

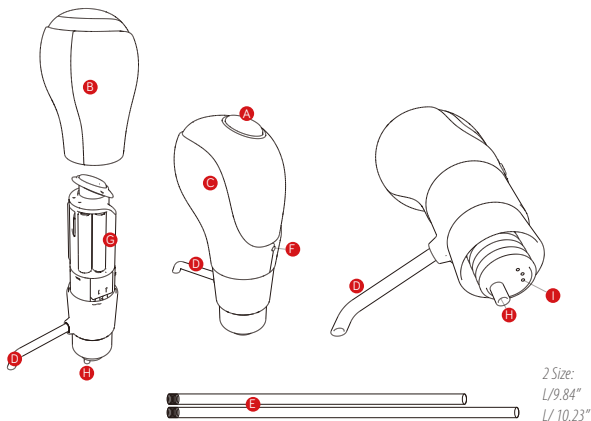

- N** • The Aerator uses 4x AAA batteries. Batteries not included.
 • The Waerator includes 1x extra tube.

Section 3. Product Information

3.1 – What is the Waerator Instant Wine Aerator?

The Waerator Instant Wine Aerator is an electric device that provides a way to taste wine the way makers intended: after it has had a chance to breathe. Unlike traditional aerators, the Waerator infuses wine with air instantly at the touch of a button.

With the Waerator, no special decanters or processes are needed. Attach the Waerator directly to the desired bottle of wine, hold a glass under the spout, and press the button. It's that easy.

The true qualities of many wines are only revealed through aeration. The Waerator is best paired with bold red wines, dry, full-bodied white wines, fresh wines with prominent tannins, and aged wines with visible sediment.

3.2 – Battery Information

The Waerator requires four standard or rechargeable alkaline 'AAA' batteries which will be stored inside the battery compartment and protected with a cover. New batteries should be installed after receiving any low battery warnings. Expected battery life is approximately 50 days when used up to twenty uses per day.

3.3 – Specifications

This user manual will guide you through the functions and usage of your Waerator Instant Wine Aerator. It is important that you follow all instructions and regard all notes that appear throughout this manual. Consult this manual before you attempt to use your Aerator. If you have questions not answered by this manual or are in need of service, contact customer support at 855-850-8035. Before contacting customer support, please have your purchase information ready as this may be needed during the call. This information may be recorded below.

Items	Parameters
Dimensions	2.7 x 2.57 x 6.49in (69 x 65.5 x 164.9mm) 2.7 x 2.57 x 15.9in (69 x 65.5 x 404.9mm) with tube
Power Source	4x Standard or Rechargeable AAA Batteries
Weight	0.45lbs (205g)
Pump Flow	60.9 – 676 oz/min (1.8 – 2.0 L/min)
Pressure	100 Kpa (14.5 psi)
Volume	1.2 oz/2sec

Section 4. **Cleaning the Waerator**

It is highly recommended that you run clean water through the Waerator before using it in order to clear out any dust or debris that may have settled inside the spout or nozzle during shipping.

- Step1.** Remove the cover, place 4 AAA batteries into the battery compartment.
- Step2.** Replace the cover then take an empty wine bottle and fill it with clean water.
- Step3.** Connect the tube to the Waerator by pressing the end with the cap onto the nozzle.
- Step4.** Place the Waerator over the mouth of the bottle making sure to thread the tube through the neck.
- Step5.** Place a glass or other container under the Waerator's spout.
- Step6.** Press and hold the button to use the Waerator. Continue until all the water has been used up.
- Step7.** Repeat this process at least 3 times to fully wash out the Waerator.



- *Use a dry, non-abrasive cloth to gently remove debris and/or wipe the outside of the Aerator.*
- *Never spray liquid directly onto any part of the Aerator. Only wine and water may only come in direct contact with the tubes, nozzle, and injection openings.*
- *After cleaning the Aerator, allow 24 hrs drying time. Check all parts before reinstalling.*
- *Never use cleaning solutions. Only water may be used during cleaning.*
- *Do not expose the Aerator's Electric parts to water, moisture, or liquids. If water enters the Electric parts of the Aerator, these components may sustain serious internal damage.*

Section 5. How to Use the Waerator

! *It is highly recommended that you run clean water through the Waerator before using it for the first time. Refer to Section 4 for basic instructions then refer back to this section for images as needed.*

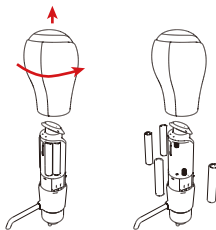

Step1. Remove the cover, place 4 AAA batteries into the battery compartment.



Step2. Reinstall the cover and turn it clockwise to lock in place.

Step3. Press the button on top to check that the Waerator is working.

Step4. Connect the tube to the Waerator by pressing the end with the cap onto the nozzle. Your Waerator Instant Wine Aerator is now ready to use!

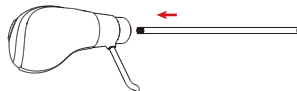

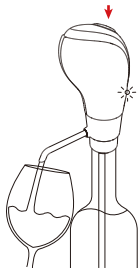

Step5. Open a bottle of wine and place the Waerator over the mouth of the bottle making sure to thread the tube though the neck.

Step6. Place a glass under the spout.

Step7. Press and hold the button to dispense aerated wine into the glass. As the Waerator dispenses, the Indicator will light up.

Step8. Release the button when the glass is filled to the desired level.

Step9. Enjoy!

- The button on top of the Waerator must be fully depressed in order to aerate and dispense at the proper speed and amount.
- The tubes the Waerator uses work best with standard-sized wine bottles (750ml). Using the Waerator with special bottles may cause the tube to rest unfavourably on top of the punt, which may negatively affect the flow of the wine.

After using the Waerator to aerate and dispense a whole bottle of wine, 1-2 oz of wine will remain due to the device's design and the design of most wine bottles. When the bottle is nearly empty, the Waerator may begin to dispense a froth of wine and air. To prevent any spray or resulting stains, keep your glass near the spout's opening to collect all of the mixture.



Section 6. Storage Information

Before storing your Aerator, note the information below.

- ! • *Turn off the Aerator before storing it.*
- *If storing the Aerator for more than 1 month, remove the batteries and store separately.*
- *Cover the Aerator to keep dust out. As, with all Electric devices, dust may cause damage over time.*
- *Store the Aerator indoors at a dry and stable temperature. Do not store in an unheated garage, shed, or other location with extreme temperature fluctuations.*

Section 7. Disposal at End-of-Life

This product must not be disposed of by incineration, landfilling, or mixing with household trash. Improper disposal of the battery contained within this product may result in the battery heating up, rupturing, or igniting which may cause serious injury. The substances contained inside the battery present chemical risks to the environment. The recommended disposal for any Waerator Instant Wine Aerator at its end-of-life is to dispose of the entire unit at or through an e-waste recycling center, program, or facility. Local regulations and laws pertaining to the recycling and disposal of lithium ion batteries and/or products containing them will vary according to country, state, and local governments. You must check laws and regulations corresponding to where you live in order to properly dispose of the battery and/or unit. It is the user's responsibility to dispose of their waste equipment properly with accordance with local regulations and laws.

For additional information about where you should drop off your batteries and electrical or Electric waste, please contact your local or regional waste-management office, your household waste disposal service, or your point-of-sale.

Section 8. **Warranty**

8.1 – Violation

The Waerator cannot be repaired or serviced within its warranty period if any of the following has occurred:

- The warranty has expired
- Damage occurred during or in relation to non-routine and/or unauthorized disassembly
- Failure to provide a valid proof of purchase when requesting service or repair
- Damage occurred as a result of natural disaster etc.
- Damage occurred due to unexpected factors or man-made reasons (including mis-operation, fluid found in any openings, improper insertion or pulling, hauling, bumping, improper voltage input and others)

8.2 – Information

One Year Limited Hardware Warranty

Your Waerator Instant Wine Aerator ("Product") includes a One Year Limited Hardware Warranty ("Warranty"). The Warranty covers product defects in materials and workmanship under normal use. This Warranty is limited to residents of the United States and Canada only and is available only to original purchasers. This Warranty gives you specific legal rights and you may also have other rights which vary from state to state.

This Warranty starts on the date of your purchase and lasts for one year (the "Warranty Period"). The Warranty Period is not extended if the Product is repaired or replaced. We may change the availability of this limited warranty at our discretion, but any changes will not be retroactive.

Warranty services are provided by Warranty Pro ("WP"). If a hardware defect arises and a valid claim is received within the Warranty Period, at its option and to the extent permitted by law, WP will: (1) repair the hardware defect by using new or refurbished parts that are equivalent to new in performance and reliability; or (2) exchange the Product with a product that is new or refurbished which is substantially equivalent to

the original product. This Warranty is for one replacement only of like-items and does not cover items out of production if the product is no longer made or stocked. This Warranty is not assignable or transferable. The original purchaser may call WP's toll-free number at 855-850-8035 for service request.

When a product or part is exchanged, any replacement item becomes your property and the replaced item becomes WP's property. This warranty only covers technical hardware defectiveness during the warranty period and under normal use conditions. WP does not warrant uninterrupted or error-free operation of this Product.

This Warranty does not cover any damage due to: (a) transportation; (b) storage; (c) improper use; (d) failure to follow the product instructions or to perform any preventive maintenance; (e) modifications; (f) unauthorized repair; (g) normal wear and tear; or (h) external causes such as accidents, abuse, or other actions or events beyond our reasonable control.

Important: Do not disassemble the Product. Disassembling the Product will void this Warranty. Only WP or a party expressly authorized by WP should perform service on this Product.

DISCLAIMER OF WARRANTY: THE REMEDIES DESCRIBED ABOVE ARE YOUR SOLE AND EXCLUSIVE REMEDIES AND OUR ENTIRE LIABILITY FOR ANY BREACH OF THIS LIMITED WARRANTY. OUR LIABILITY SHALL UNDER NO CIRCUMSTANCES EXCEED THE ACTUAL AMOUNT PAID BY YOU FOR THE DEFECTIVE PRODUCT, NOR SHALL WE UNDER ANY CIRCUMSTANCES BE LIABLE FOR ANY CONSEQUENTIAL, INCIDENTAL, SPECIAL OR PUNITIVE DAMAGES OR LOSSES, WHETHER DIRECT OR INDIRECT.

SOME STATES DO NOT ALLOW THE EXCLUSION OR LIMITATION OF INCIDENTAL OR CONSEQUENTIAL DAMAGES, SO THE ABOVE LIMITATION OR EXCLUSION MAY NOT APPLY TO YOU.

THE DURATION AND REMEDIES OF ALL IMPLIED WARRANTIES, INCLUDING WITHOUT LIMITATION THE WARRANTIES OF MERCHANTABILITY AND FITNESS FOR A PARTICULAR PURPOSE ARE LIMITED TO THE DURATION OF THIS EXPRESS LIMITED WARRANTY.



Instant
Wine Aerator