

IMPORTANT NOTICE

Please read operating instructions before using this product. Please keep original box and packing materials in the event that service is required.

For questions or concerns please contact customer service at:

Synergy Housewares, LLC.
Toll-free: 866-444-4033
Hours: M-F 8:30am-5:00pm EST
Website: warranty.synergyhousewares.com
Printed in China

Model SWPBMG100

WOLFGANG PUCK

USE AND CARE

COFFEE GRINDER



Actual product may differ slightly from images in this manual
Wolfgang Puck is a trademark of Wolfgang Puck Worldwide

Model SWPBMG100

IMPORTANT SAFEGUARDS

When using electrical appliances, basic safety precautions should always be followed, including the following:

1. Read all instructions carefully.
2. To protect against risk of electric shock, do not put appliance, cord, or plug in water or other liquid.
3. This appliance is not intended to be used by children or by persons with reduced physical, sensory or mental capabilities, or lack of experience and knowledge unless they are closely supervised and instructed concerning the use of the appliance by a person responsible for their safety.
4. Close supervision is necessary when any appliance is used near children. Children should be supervised to ensure that they do not play with the appliance.
5. Cleaning and user maintenance shall not be made by children without supervision.
6. Keep the appliance and its cord out of reach of children.
7. Turn the appliance off and then unplug from outlet when not in use, before assembling or disassembling parts and before cleaning. To unplug, grasp the plug and pull from the outlet. Never pull from the power cord.
8. Avoid contacting moving parts.
9. Do not operate any appliance with a damaged cord or plug or after the appliance malfunctions or is dropped or damaged in any manner. Contact Synergy Housewares at 800-275-8273 for information on examination, repair, or adjustment.
10. Always check Bean Container for the presence of foreign objects before using.
11. The use of attachments not recommended or sold by Synergy Housewares may cause fire, electric shock, or injury to persons.
12. Do not let cord hang over edge of table or counter or touch hot surfaces, including the stove.
13. Do not place the appliance on or near a hot gas or electric burner or where it could touch a heated oven.
14. Do not use this appliance for other than its intended use to avoid potential injury.
15. Always operate appliance with Bean Container Lid in place.
16. Do not leave appliance unattended while it is operating.
17. Do not operate in the presence of explosive and / or flammable fumes.
18. Ensure that the Burr Disc Holder is locked into the Bean Container securely with the Protection Cap locked over the Burr Disc Holder (see "Assembling Your Coffee Grinder"). Injury can result if moving blades accidentally become exposed. Blades are sharp. Handle carefully.
19. Do not run motor while the bean container is empty.
20. The working time of the appliance should not exceed 2 min.
21. Do not use appliance for other than intended use.

SAVE THESE INSTRUCTIONS
HOUSEHOLD USE ONLY

Additional Safety Information

Power cord instructions:

A short power-supply cord is provided to reduce the hazards resulting from entanglement or tripping over a long cord. If it is necessary to use an extension cord, it should be positioned such that it does not drape over the counter or tabletop where it can be pulled on by children or tripped over and:

- A. The marked electrical rating of the extension cord should be at least as great as the electrical rating of this appliance and,
- B. The extension cord should be arranged so that it will not drape over the countertop or table top where it can be pulled on by children or tripped over unintentionally.

Polarized Plug:

This appliance has a polarized plug, (one blade is wider than the other). As a safety feature to reduce the risk of electrical shock, this plug is intended to fit in a polarized outlet only one way. If the plug does not fit fully in the outlet, reverse the plug. If it still does not fit, contact a qualified electrician. Do not attempt to defeat this safety feature or modify the plug in any way.

Before Your First Use

Unpack the Coffee Grinder and remove all packaging materials carefully.

Clean the appliance according to the "Care & Cleaning" section.

Place the Coffee Grinder on a dry, level surface. Do not plug the Coffee Grinder into an outlet until it is completely and properly assembled.



In the beginning, there was Wolfgang Puck. There were cooks and there were kitchens and there were people eating food, but the world had never seen anything like Spago—with its California cuisine, its casual elegance, and its chef whose genuine warmth and love of craft redefined the dining experience. And they came—from LA and from everywhere—to experience the future. Wolfgang Puck shaped the modern culinary landscape: he was the first celebrity chef, the inventor of fusion cuisine, the first in farm-to-table. His work is inspired by California living, and an insistence on only the freshest ingredients. From

his legendary fine dining icons, his entrepreneurial spirit has built an empire—from dining, to catering, to products for the home—touching the lives of millions around the globe. Today, as always, Chef Puck is earnestly, restlessly, tirelessly at work behind the scenes inventing what's next. He is driven by a genuine love of his craft, a passion for what's possible, and its potential to change the world.

Table of Contents

Important Safeguards.....	2
Additional Safety Information	3
Before Your First Use.....	3
About Wolfgang Puck.....	4
Know Your Coffee Grinder	6
Assembling Your Coffee Grinder.....	8
Using Your Coffee Grinder.....	8
Care and Cleaning	9
Limited Warranty	11
Contact Information	Back

Know Your Coffee Grinder

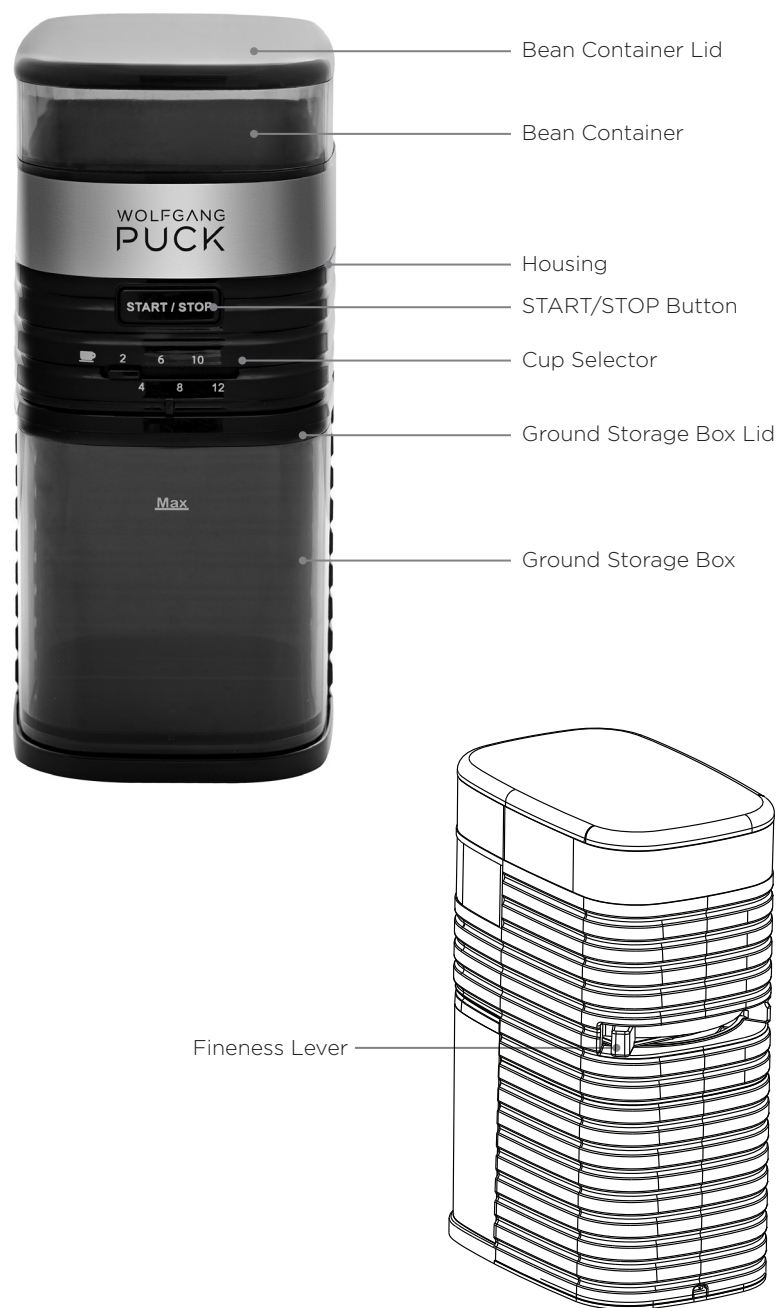

Actual product may differ slightly from illustrations on this page

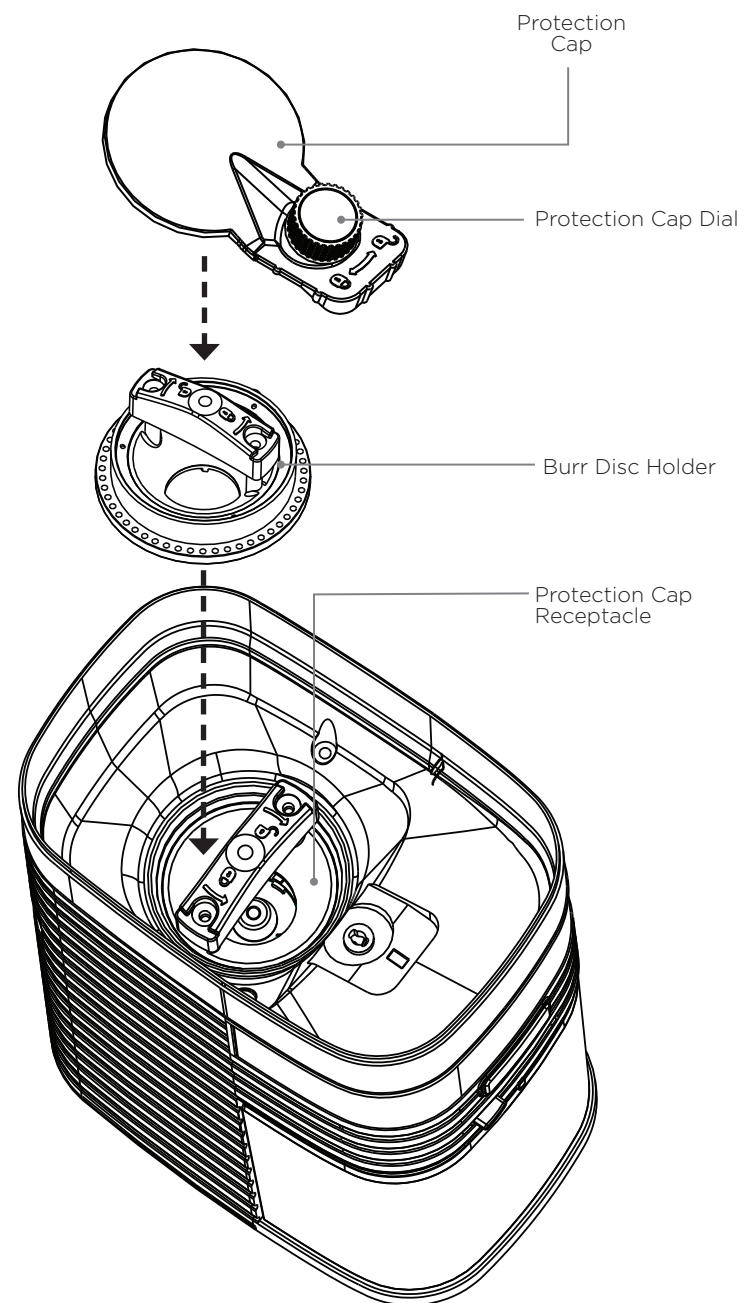

Assembling Your Coffee Grinder

1. Place the Coffee Grinder on a flat, level surface.
2. Insert the Burr Disc Holder into the Bean Container then secure it in place by turning counterclockwise until it hits stops.
3. Ensure the Dial on the Protection Cap is in the unlock position. Rest the large circle over the Burr Disc Holder then line up the Dial over the hole in the receptacle of the Bean Container. Secure it in place by turning the Protection Cap Dial clockwise until it stops.
4. Place the Bean Container Lid on top of the Bean Container.
5. Place the Ground Storage Box Lid onto the Ground Storage Box.
6. Insert the Ground Storage Box fully into the Housing.
7. Plug the appliance into a 120VAC 60 Hz outlet only. Your Coffee Grinder is now ready for use.

Using your Coffee Grinder

1. Make sure the unit is unplugged.
2. Remove the Bean Container Lid.
3. Fill the Bean Container to the top, leaving enough room for the Bean Container Lid to fully nest on top.
4. Ensure that the Ground Storage Box with Ground Storage Box Lid is fully seated into the Housing.
5. Plug the power cord into the outlet.
6. Use the Fineness Lever located on the back of the unit to adjust the fineness of the coffee grounds. The Fineness Lever can be adjusted from 1 for maximum grind coarseness to 12 for maximum grind fineness.

Note: Use coarse grind for percolator/French press; medium grind for automatic drip and fine grind for espresso.

7. Slide the Cup Selector to the desired number of cups: 2 - 12. You can make adjustments based on personal preference by adjusting the cup selection to make your coffee stronger or weaker.
8. Press the START/STOP Button to begin grinding.

Note: The Coffee Grinder has a safety feature that prevents it from operating without the Protection Cap properly installed in the Bean Container and the assembled Ground Storage Box With Ground Storage Lid fully seated into the Housing.

9. Grinding will automatically stop upon completion.
10. To manually stop the operation, press the START/STOP Button once and the unit will stop. To restart, press the START/STOP Button again, or repeat steps 6 & 7 for different adjustments before pressing the START/STOP Button to begin grinding.
11. Remove Ground Storage Box and use as desired.

Care and Cleaning

Always unplug Coffee Grinder before cleaning.

Do not immerse the Housing, cord or plug in water. Simply wipe the Housing with a damp cloth.

Do not use abrasive cleaners or scouring pads on any part of the Coffee Grinder.

All removable parts listed below are top rack dishwasher safe or can be washed in warm soapy water. Rinse and dry thoroughly after each use.

Removable Parts List:

- Bean Container Lid
- Ground Storage Lid
- Ground Storage Container
- Burr Disc Holder
- Protection Cap

Store the Coffee Grinder in a safe location out of the reach of children.

Any other servicing should be performed by an authorized service representative.

Notes

Limited Warranty

This warranty covers all defects in workmanship or materials in the mechanical and electrical parts, arising under normal usage and care, in this product for a period of 12 months from the date of purchase provided you are able to present a valid proof-of-purchase. A valid proof-of-purchase is a receipt specifying item, date purchased, and cost of item. A gift receipt with date of purchase and item is also an acceptable proof-of-purchase. Product is intended for household use only. Any commercial use voids the warranty.

This warranty covers the original retail purchaser or gift recipient. During the applicable warranty period within normal household use, we will repair or replace, at our discretion, any mechanical or electrical part which proves defective, or replace unit with a comparable model.

To obtain service under the terms of this warranty, call Toll Free (866) 444-4033.

THIS LIMITED WARRANTY COVERS UNITS PURCHASED AND USED WITHIN THE UNITED STATES AND CANADA AND DOES NOT COVER:

- Damages from improper installation.
- Defects other than manufacturing defects.
- Damages from misuse, abuse, accident, alteration, lack of proper care and maintenance, or incorrect current or voltage.
- Damage from service by other than an authorized dealer or service center.

This warranty gives you special legal rights and you may also have other rights to which you are entitled which may vary from state (province) to state (province).

Proof of purchase required to validate the warranty.

Shipping and handling charges may apply.