



USER MANUAL FOR 27,5" CRUISE E-BIKE

ROVER

Please read this manual before using your e-bike
and contact us if there are any issues.

DO NOT RETURN TO STORE.

Mizari Enterprises, Inc. Support@mizari.com 1-877-506-4900

Page 3-4	EN	CONSUMER WARNINGS AND INTRODUCTION
Page 5-7	EN	DISPLAY, BUTTONS AND BASIC CONTROLS
Page 7-9	EN	ADDITIONAL CONTROLS AND DISPLAY INFORMATION
Page 10	EN	THROTTLE AND PEDAL ASSEMBLY
Page 11	EN	FRONT TYRE ASSEMBLY
Page 12	EN	BRAKE ADJUSTMENT
Page 13	EN	SADDLE ADJUSTMENT
Page 14	EN	PEDALING POWER
Page 15-16	EN	BATTERY INFORMATION AND CHARGING THE BATTERY
Page 17	EN	TRAVEL DISTANCE AND RIDING INFORMATION
Page 17-18	EN	SAFE RIDING GUIDANCE
Page 19-20	EN	CARRYING THE E-BIKE AND MAINTENANCE
Page 21	EN	WARRANTY AND CUSTOMER SERVICE
Page 22-23	EN	CAUTIONS AND WARNINGS

RE-C275L50013

CRUISE E-BIKE

E-BIKE WARNING

This e-Bike is not a toy and is intended for riders aged 12 and above. Adult supervision is required for all minors. Any riders that lack experience and knowledge of riding an e-Bike require adult supervision and instruction to ensure safe use of the e-Bike.

RIDING ANY VEHICLE CAN POSE RISKS AND DANGER TO YOU AND THOSE AROUND YOU. BY USING THIS PRODUCT, YOU KNOWINGLY ASSUME THOSE RISKS AND RESPONSIBILITIES. PLEASE USE CAUTION WHEN RIDING THIS E-BIKE.

BATTERY NOTICE

The battery must be regularly charged, even when not in use.

Keep the battery out of the reach of small children.

The battery must be removed from the e-Bike if it is ever to be scrapped.

Disposal of any battery requires that you do it safely and in compliance with your local laws.

INTRODUCTION

Before riding your e-Bike, please read this product manual carefully, and keep it handy for future reference.

In order to avoid damage to your e-Bike, please follow and understand instructions found in this user manual.

You are responsible for all damage, injury, or other consequences of incorrect use of this e-Bike.

The Retailer and the Distributor shall bear no responsibility for damage, injury, or other consequences of incorrect use of this e-Bike.

This e-Bike may only be ridden by one person at a time.

Please do not ride the e-Bike if there is any damage or if the e-Bike or tires require maintenance.

Always ride under control, as loss of control could result in serious injury to you or others.

Intended for use only as permitted by local laws and regulations.

Follow all instructions in this user manual to avoid technical problems.

Contact Mizari Customer Support if there are any problems with your product.

Before riding your e-Bike, please fully charge the battery with the supplied battery-charger,

Recharge the battery any time the level is low.

Do not touch the battery or charger when your hands are wet to avoid possible shock or short-circuit.

Do not dismantle the bike. If need you need parts or service, contact Mizari Customer Support.

ATTENTION

The rechargeable battery is the energy source for your e-Bike and should be fully powered before each use.

Be sure to charge the battery regularly, for at least 4-6 hours, even if you will not be riding it for an extended period of time.

A depleted battery that is not regularly recharged will result in decreased performance or possibly a dead battery.

Be sure to fully charge the battery at least every 2 months (for 4 to 6 hours), even when the e-Bike is not used.

DISPLAY, BUTTONS AND BASIC CONTROLS

The LED display is on top of the handlebar, in front of the user.



There are 5 buttons on the controller to manage the display:

Power button

Input button (i)

Light button

Adjustment button plus/up (+)

Adjustment button minus/down (-)

USB power port in front for all devices



ON THE DISPLAY:

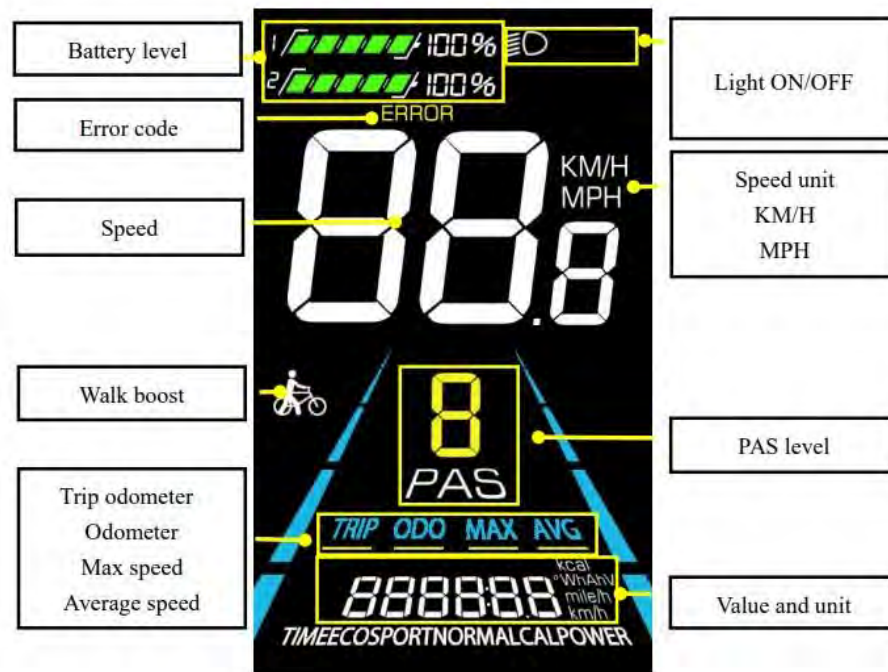

Power on/off

After charging the battery, long press the power button on the display to turn on the display and show the start-up interface (current speed and trip odometer).

Long press the power button again to power off the display.

The unit will automatically turn off when not in use after 10 minutes.

Power assistance speed selection

Press adjustment button (+ or -) to switch from Gear 1 to Gear 2, and from Gear 2 to Gear 3. There are five modes in total. When the

display is turned on, the default gear is 0 with no power-assistance. The output power is zero at level “0”. Level “1” is the minimum output power. Level “5” is the maximum output power.

Current Display Setting

The first display is about current speed and trip ODO by default.

Press the “i” button on the controller to switch from trip distance (miles/km) to ODO (total mileage), to max speed and average speed.

User Adjustment Setting

In order to change user settings, the bicycle must be stationary, with the display ON and speed at 0.

Press and hold “+” and “-” buttons simultaneously to activate user settings. In the user setting screen, short press + / - buttons to set some info. When done, press “i” button again to confirm the input and save the setting. Hold the “i” button for more than 2 seconds to store the setting and exit the current setting. Hold the “-” button for more than 2 seconds to cancel the operation and to exit user settings. The display will also exit user settings after around 1 minute of no input.

“01P” is the unit setting, 00 for metric and 01 for imperial.

“04P” is backlight setting: level 1 is the lowest brightness, level 3 the highest brightness. Press “i” to change these parameters. Press + / - button to increase or decrease the desired level and “i” button again to store the changed setting.

Headlights

Press “light” key on the controller to turn the front and rear lights on, and to dim the display backlight.

Press again to turn the lights off and restore the backlight brightness.

ADDITIONAL CONTROLS AND DISPLAY INFORMATION

Battery capacity

Battery capacity is displayed with five bars to show 100% (full battery) down to no bars for 0% (empty). One bar indicates a very low battery that should be fully recharged. As you ride and use the PAS, the power of the battery will gradually decrease. The higher the PAS, the faster it will decrease.

Gears and Speed

Gear 1 is for maximum speed of **around 12mph**, gear 2 is maximum speed of **around 14mph**, gear 3 is maximum speed of **around 16mph**, gear 4 is for maximum speed of **around 18mph**, gear 5 is maximum speed of **around 20mph**. When the e-Bike reaches

maximum speed in any gear, PAS will not accelerate beyond that speed.

Although you can change gears while the e-Bike is moving, for safety reasons, we recommend changing gears while the e-Bike is stopped.

Push-assistance Mode (walk boost)

Long press the “-” button to activate the push-assistance mode, which helps push while you are walking the bike (up to a speed of 6Km/h). The push-assistance function indicator switches off as soon the “-” button is released.

Trip odometer reset operation

The display can record trip odometer and odometer. Trip odometer is not automatically reset after turning off the display. The odometer can not be reset. The trip odometer can be reset: in the setting interface and 0 speed, press and hold “+” and “|” simultaneously for 2 seconds. The main interface will flash during the reset process.

Current speed

The speed is shown in miles/h. It will change along with the current speed.

Fault Codes

Display fault code will appear:



When one of these error codes appear on the display, kindly contact Mizari Customer Support for immediate assistance. The error is likely due to a communication problem between the controller and the display.

The motor and display may not function, but the bike can still be ridden used as a normal bike.

Fault codes:

"E021"	current failure	Damaged cable. Check for assistance.
"E022"	throttle failure	Check throttle. Check for assistance.
"E023"	motor phase abnormality	Motor cable is not well plugged, or it is damaged. Check for assistance.
"E024"	failure of motor's hall signal	Motor cable is damaged. Check for assistance.
"E025"	brake failure	Brake is not fully plugged. Check for assistance.
"E030"	communication failure	Controller problem. Check for assistance.

THROTTLE

Even though your e-Bike is equipped with pedal-assist (PAS), that activates the motor whenever you pedal, it also features a manual throttle that will override the PAS and power the motor even if you are not pedaling.

The throttle control is found on the left side of the handlebar, as shown in the image. To activate the throttle, press the lever. The more you press the more you will accelerate. To slow down, release the lever as far as needed. To disengage the throttle completely, release the lever and the PAS system will be active again, powering only when you pedal.



ASSEMBLING THE PEDALS

“L” is the left pedal, “R” is the right pedal.

If not already installed, insert the pedals into the end of the crank. Screw them in by hand and then use an adjustable wrench to finish tightening the pedals in place.

ASSEMBLING THE FRONT TIRE

The quick release clip shown in the picture is used to clamp the front wheel to the fork. It is made to be used by hand and does not require any tools. Please do not use tools on the quick release clip to lock or unlock it.



Make sure that the quick release is in the open position.

Unscrew the nut on the quick release axle as shown in the image below.

Slide the quick release axle through the center hole of the wheel, and then put the nut back on the axle.

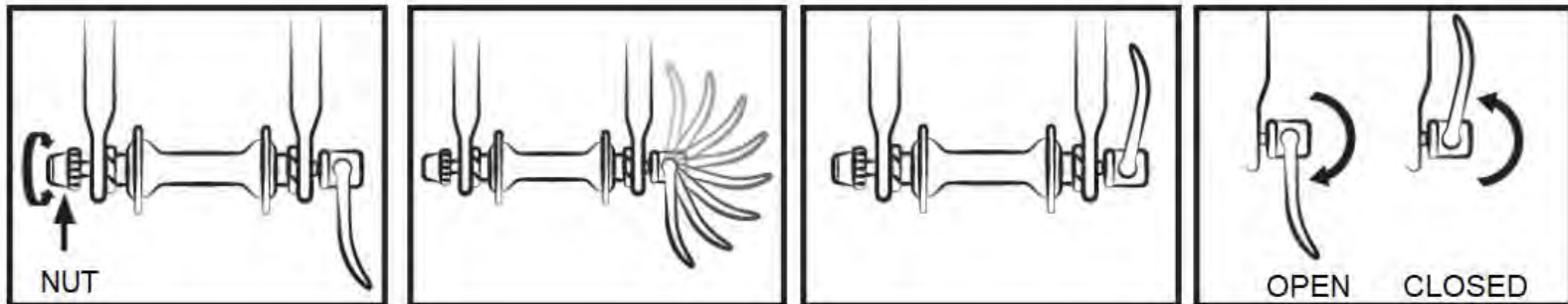

Make sure the axle is fully inserted into the fork, then lock the axle by closing the lever. Check that the word “close” is visible and that the lever is pushed fully to the closed position, as shown in the image. If the lever will not fully close, you can release the lever and adjust the nut on the other side, loosening a little at a time, then lock it again until it closes fully. If the lever is loose when fully closed, unlock it and tighten the nut little by little until it securely locks in the closed position. Align the lever to the fork leg when closing.

BRAKE ADJUSTMENT

When adjusting the brake, you want the brake pad to grip the brake disc tightly when the brake lever on the handlebar is about half way. If the brakes are too tight or too loose, you can use the brake cable tension adjusting screw to adjust the brake tension. You can adjust the brake tension with screw “A” shown in the diagram.

Unscrew “A” to reduce the amount of lever travel (tighten brakes).

Tighten screw “A” to increase the lever travel (loosen brakes).

In case you have fully unscrewed “A” and the brakes are still not tight, you will need to adjust the space between the pads and the disc.

Please contact Mizari Customer Support for any issues with brake adjustments.

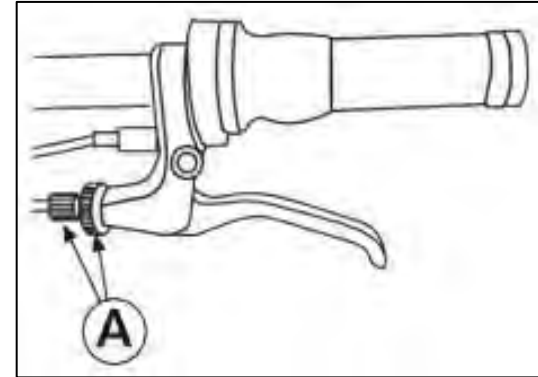

SADDLE ADJUSTMENT

You can adjust the seat height by releasing the clamp at the base of the seat and raising or lowering the bar to the desired height. There is a minimum insertion marking that should not be visible, as shown in the flowing diagram. Make sure the seat does not touch other parts of the bike, like tire, fender, or luggage rack.

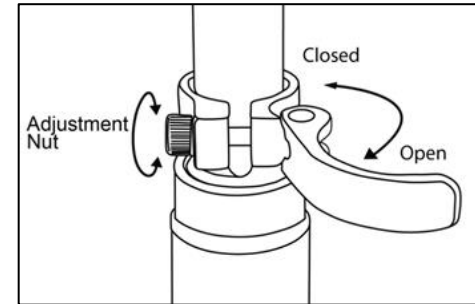

The ideal riding height is when your toes are on the pedal at the bottom pedal position and your knee can bend slightly (illustration A). A good way to set the correct height is to sit with your leg straight and heel on the pedal at the bottom position (illustration B).

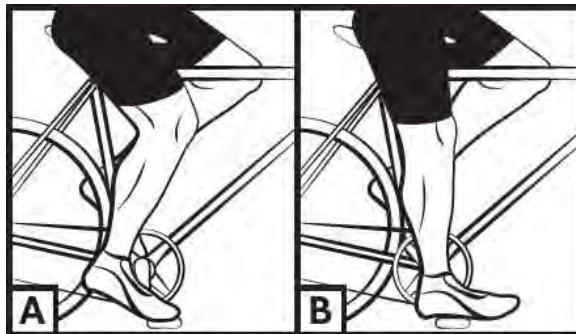

PEDALING POWER

Your e-Bike is equipped with a pedal-assist (PAS) motor. The faster you pedal, the stronger the motor will run, until reaching the maximum speed for each gear, as explained previously in the Gears and Speed Section. When you stop pedaling, the motor will stop. Here are some other things to know about PAS:

- When you pedal and the motor starts, you will feel a sudden “push,” so get comfortable with this sudden burst and beware when engaging the motor in traffic or crowded areas.
- If the battery is dead or you have removed the battery, you can still use your e-Bike as a normal bicycle with no PAS.
- The maximum speed is 20 miles/hour, so the motor will not go beyond that, no matter how hard you pedal.
- The maximum range of your fully charged e-Bike varies greatly depending on a number of factors, such as: road surface, slope of the terrain, ambient temperature, tire pressure, weight of rider, and the gear/speed you use, among other factors. Please take these factors into consideration when planning your ride.

ABOUT THE BATTERY

This e-Bike uses a lithium-ion battery. In order to extend your battery life:

- Always charge the battery when it is low or empty.
- Even if it is not used for long periods of time, you must fully charge the battery at least every 2 months.
- Once the battery is fully charged, it is best to unplug the power adapter.
- If the bike is not used for long time, it is suggested to remove the battery from the bike and store the battery properly. Storage conditions of the battery pack is the ambient temperature (20~25°C).

WARNING

The battery must be fully charged at least every 60 days (for 4-6 hours), even when the e-Bike is not being used, or the battery may fail to hold a charge. Do not to leave the charger plugged in after the battery is fully charged or it could reduce your battery life.

CHARGING THE BATTERY

Before using the bike for the first time, fully charge the battery. A normal charge lasts 4-6 hours approximately.

The charger port is located near the key lock, on the battery block, as pictured here.

Use the original charger only. Do not use a car cigarette kit to charge the battery.

Charging should be in a safe, dry, and clean environment.

Do not charge the battery if the temperature is less than 32°F/0°C.

To charge:

1. Turn off the bike.
2. Ensure the charging port is dry.
3. Open the cover and insert the charger plug into the bike charging port first.
Then, plug the other end of the charger into a power socket.
4. The charger light will be **red** to indicate that the battery is charging.



5. After as much as 4-6 hours of charging, the charger light will turn **green** to indicate the battery is fully charged.
6. When charging is finished, remove the plug from the e-Bike's charging port and disconnect the power plug from the electrical outlet. Close the protection cover and you are ready to go.

HOW TO CHECK THE BATTERY LEVEL

Battery level is shown on your display when it is turned on.

When battery is removed by the frame of the e-bike, you can also check the charge level on the battery itself by pressing the power button on the top of the battery. The LED lights up to indicate the level of charge: blue (full charged battery), green (around half charge), red (less than 20% power).



BATTERY REMOVAL

If necessary, the battery can be removed from the e-Bike.

Be sure the e-Bike is turned-off. The display must be off. Insert the key in the lock and turn it to unlock the battery box. Insert the key that came with your e-Bike in the lock and turn it to the OPEN position. Remove the battery from the frame of the e-Bike by pulling it up.

WARNING

Remember to remove the key and keep it safe after removing the battery from the e-Bike!

BATTERY INSTALLATION

Follow these prior instructions in reverse order to insert the battery back into its compartment.

WARNING

Remember to remove the key and keep it safe after removing the battery from the e-Bike!

TRAVEL DISTANCE RANGE FACTORS

The maximum range of your fully charged e-Bike is estimated at 24-31 miles (40-50 km).

However, be aware that this range varies greatly depending on a number of factors, such as: road surface (smooth & flat vs. rough & hilly), ambient temperature (cool vs. hot), tire pressure (correct vs. incorrect), weight of rider (lighter vs. heavier), acceleration (slow & steady vs. fast & furious), and gear/speed you use, among other factors.

Please be sure that if you need to get back to where you started your ride, keep an eye on your battery level indicator and turn back once your battery level is at 50%. If you need to extend battery life during your ride, switch to a lower gear.

ABOUT RIDING

In order to ensure your safety, please check the following before every ride:

- Is the tire pressure correct?
- Are all screws and latches fully tightened?
- Is the battery charged?
- Are the brakes tightened correctly?
- Are the handlebars and seat height adjusted properly?

WARNING

To prevent the e-Bike from accidentally moving when parked, turn off the power switch when you get off the bike,

SAFE RIDING GUIDELINES

1. Please read and understand this manual before riding your e-Bike.
2. For your safety always wear a helmet when riding.
3. Wear comfortable flat shoes – sandals, slides or flip-flops are not recommended.
4. Always know and follow your local laws and regulations regarding e-Bikes and electric vehicles.

5. Regularly check the battery level so that you do not run out of power during your ride.
6. Please check any rules or restrictions on rider age in your location.
7. Adult supervision is recommended for riders under age 18.
8. This e-Bike is for personal use only and is not intended for commercial use or public transportation.
9. Only ride where it is permitted by your local laws and regulations.
10. Do not carry goods or packages while riding the e-Bike, and always keep both hands on the handlebar.
11. Pay close attention to your surroundings, including obstacles, cars, bikes, and pedestrians.
12. Do not start or stop too abruptly.
13. Avoid rough and uneven surfaces, especially holes, bumps, humps, and jumps.
14. Do not ride up or down stairs or escalators.
15. Do not ride under the influence of alcohol or drugs.
16. The e-Bike may only be ridden by one person at one time, regardless of maximum weight allowed.
17. Riders in excess of the maximum weight of 120 kg/264 lbs could irreparably damage the e-Bike and void your warranty.
18. Riders below the minimum weight of 30 kg/70 lbs could lose control of the e-Bike and injure themselves or others.
19. Always maintain a safe distance between you and other traffic to avoid risk of collision or injury.
20. If riding in rain or snow, avoid puddles that could get water on electrical components and damage electrical systems.
21. Avoid ice, mud, or other slippery conditions where you could lose control of the e-Bike and injure yourself or others.
22. Keep the e-Bike away from fire and open flames.

HOW TO CARRY AND TRANSPORT THE E-BIKE

1. To carry your bicycle, lift it at the middle of main frame to balance it. **NEVER lift the e-Bike by the handlebar, front stem, seat, or wheels.**
2. If transporting your e-Bike in a car, secure it to a bicycle rack as instructed by the rack manufacturer. **Do not hang the e-Bike on a rack using the handlebar, front stem, seat, or wheels.**
3. When transporting your e-Bike in the rain, try to cover any areas where water might enter the electrical systems to avoid water damage.
4. If you are transporting your e-Bike inside of a vehicle, like in the trunk or cargo area, please make sure that the hub gears are facing up, to prevent any damage from weight or bouncing.
5. When you arrive at your destination, carefully inspect that the e-Bike has not sustained any damage before riding.

HOW TO TRANSPORT THE BATTERY

Lithium batteries are considered dangerous goods and may not normally be shipped as cargo on airplanes. Please check local regulations when transporting the battery.

MAINTENANCE AND TROUBLESHOOTING

Your e-Bike requires routine cleaning, upkeep, and maintenance. When working on your e-Bike, make sure the power is off, the charging cable is not connected, and the rubber cover is on the charging port.

CLEANING

You can wipe your e-Bike with a soft damp cloth that will not damage the surface of the bike. You may use mild detergent to gently wipe the paint and the plastic surfaces, then dry with soft cloth.

Do not use alcohol, gasoline, kerosene or other corrosive, volatile chemical solvents for cleaning, as they may cause severe damage to the structure and components.

CAUTION

Do not use a pressure washer to clean the e-Bike. Avoid water or other liquids seeping into the e-Bike and causing permanent damage to the internal electronics.

STORAGE

Please make sure your e-Bike is fully charged before storing it. Store the e-Bike indoors, in a dry and cool place at a temperature above 32°F/0°C. If the e-Bike is stored for an extended period of time, be sure it gets a full charge at least every 60 days for 6 hours, otherwise the battery may not hold a charge and would no longer be covered under warranty. Long-term exposure to sunlight and outdoor environment will accelerate aging of the e-Bike, tires, and battery.

WARNING

Do not open the vehicle for any reason. The user is responsible of any after-effect.

KEEP TIRE PRESSURE IN RANGE

Regularly check the tire pressure indicated on the tires and maintain that pressure for best performance and comfort.

WARRANTY AND CUSTOMER SERVICE

After-Sale Customer Service

If you have any issue or problem with your e-bike, please contact us before you return it to the retailer where you purchased it. We can be reached at:

Mizari Enterprises, Inc.
Support@mizari.com
1-877-506-4900

E-BIKE WARRANTY

Carefully read all instructions before using the e-Bike. Do not use the e-Bike where it is forbidden. Do not use the e-Bike in a manner that is dangerous to you or those around you.

This product is warranted to be free from defects in materials, workmanship, and functionality (aesthetic parts are excluded) for a period of 1 year starting from the date of purchase shown on your receipt. This warranty shall not apply to any products that have been subjected to abuse, misuse, negligence, accidents, abnormal operation, or use that is specifically restricted in this manual. The warranty does not cover natural wear and tear from normal use.

Please contact Mizari Enterprises, Inc., as listed above, for any service or repair issues you may require.

DO NOT OPEN OR DISASSEMBLE THE E-BIKE AS THIS WILL VOID THE WARRANTY.

BATTERY WARRANTY

The battery, when maintained and used as described in this manual, has a 6 month warranty. Please contact Mizari Enterprises, Inc. as indicated above for any issues with the battery.

CAUTIONS AND WARNINGS

WARNING

As with any mechanical component, this e-Bike is subject to high stress and wear from normal usage. The various materials and components used to manufacture the e-Bike will react differently to its unique wear and use. If the service life for a component has been reached, it may break suddenly, with risk of harm or injuries to the user. Cracks, scratches, and discoloration in the areas subject to high stresses indicate that the component may have exceeded its service life and should be replaced.

WARNING

Do not make any repairs, alterations or modifications to the e-Bike that are not specifically detailed in this owner's manual.

WARNING

Do not open the e-Bike for any reason, as this will void your warranty. Never dismantle the battery pack, as severe accidents may occur from electric shock, short circuit, or explosion.

WARNING/ATTENTION

The battery contains dangerous substances.

Do not charge the battery if the temperature is lower than 32°F/0°C.

Do not attempt to open the battery and do not insert objects into it.

Charge and store in an open dry area, away from combustibles and open flame.

If necessary, correctly dispose of and recycle the batteries according to local recycling and environmental regulations.

Never dispose of batteries as common trash.

Never throw the batteries into fire.

The battery must be removed from the e-Bike before it is recycled or scrapped.

Only the original charger must be used.

CAUTIONS

Do not use the e-Bike if the battery is low.

Do not use the e-Bike if there is a burning smell.

Do not use the e-Bike if the battery is leaking.

Do not touch anything leaking out from the battery.

Do not let children or animals touch the battery.

Unplug the charger before riding the e-Bike.

Only use the supplied battery and the supplied charger.

Only professionals can disassemble and maintain the battery.

Please contact Mizari Enterprises, Inc. for any battery issues or needs.

Lithium batteries are considered dangerous goods and there are restrictions on transporting them, check your local regulations and laws.

DECLARATION OF CONFORMITY

We declare that the product described is in conformity with EN15194 directive.

CORRECT DISPOSAL OF THE BATTERY



This marking on battery indicates that the batteries in this product should not be disposed of with other household waste at the end of their working life. If batteries are not properly disposed of, these substances can cause harm to human health or the environment. To protect natural resources and to promote material reuse, please separate batteries from other types of waste and recycle them through your local, free battery return system. When needed, please ask your local free battery return system to remove the battery from the case.

CORRECT DISPOSAL OF THE PRODUCT



This marking on the product, accessories or literature indicates that the product and its electronic accessories should not be disposed of with other household waste. To prevent possible harm to the environment from uncontrolled waste disposal, please separate these items from other types of waste and recycle them responsibly to promote the sustainable reuse of material resources. Consumers should contact their waste-disposal company or local government for details of where and how to recycle or dispose of these materials in an environmentally safe manner.

MADE IN CHINA

Images inside this user manual are for illustrative purposes only. Our Company is not responsible for improper use of the product. Our Company reserves the right to modify the product and the content of this manual without prior notice.

IMPORTED AND DISTRIBUTED BY
Mizari Enterprises, Inc.
5455 Wilshire Blvd Ste 1410
Los Angeles, CA 90036, USA